

QMI

STORMSAFE SCREEN - OPERABLE IMPACT SCREEN - HVHZ

INSTALLATION AND ANCHORAGE DETAILS

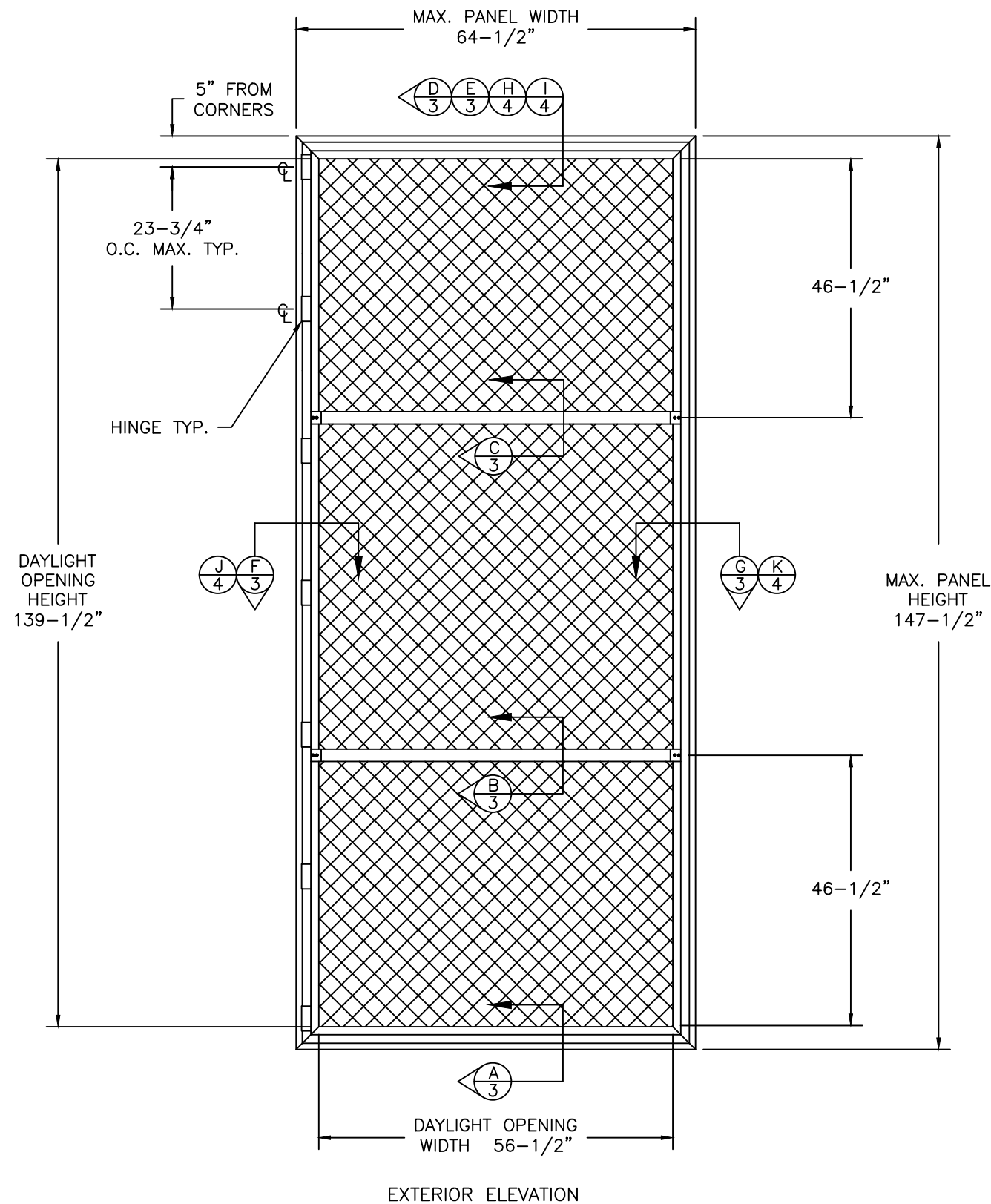

GENERAL NOTES:

1. THE PRODUCT SHOWN HEREIN IS DESIGNED AND MANUFACTURED TO COMPLY WITH THE CURRENT EDITION OF THE FLORIDA BUILDING CODE INCLUDING THE HIGH VELOCITY HURRICANE ZONE (HVHZ).
2. CONCRETE, MASONRY AND WOOD FRAMING TO BE DESIGNED AND ANCHORED TO PROPERLY TRANSFER ALL LOADS TO STRUCTURE. FRAMING IS THE RESPONSIBILITY OF THE ARCHITECT OR ENGINEER OF RECORD.
3. IMPACT SCREEN MATERIAL: 304 STAINLESS STEEL.
PANEL FRAME MATERIAL: ALUMINUM ALLOY 6005-T5.
CORNER KEY MATERIAL: ALUMINUM ALLOY 6061-T6.
4. A MINIMUM GLASS SEPARATION DISTANCE OF 4" SHALL BE PROVIDED FOR ALL INSTALLATIONS.
5. TESTING TO TAS 201, TAS 202 (STATIC LOADING) AND TAS 203 DOCUMENTED IN TEST REPORT NO. CTLA-1366W BY CERTIFIED TESTING LABORATORIES.

TABLE OF CONTENT	
SHEET	DESCRIPTION
1	ELEVATION NOTES
2	ANCHORING & NOTES
3	INSTALLATION DETAILS IN CONCRETE & WOOD FRAME
4	INSTALLATION DETAILS IN CONCRETE & WOOD FRAME
5	COMPONENTS & B.O.M.

MAXIMUM ALLOWABLE DESIGN PRESSURES W/2 1/2" MIN. EDGE DISTANCE	IMPACT RATING
+47.0 PSF -53.0 PSF	LARGE MISSILE IMPACT

PROJECT #414-1205	
	DATE 5/6/15
	BY RJA
	DESCRIPTION
	REV
	UPDATE TO 5TH ED. (2014) FLORIDA BUILDING CODE
	A

1661 GLENLAKE AVE.
ITASCA, IL 60143

QMI

TITLE: STORMSAFE SCREEN - OPERABLE IMPACT SCREEN - HVHZ
GENERAL AND INSTALLATION NOTES

PREPARED BY: RJA DATE: 12/09/12

DRAWN BY: RJA DRAWING NO: QMI0004

SCALE: N.T.S. SHEET: 1 OF 5

REV: A

PTC PRODUCT DESIGN GROUP, LLC Phone: 321.690.1788
PO BOX 530719 Fax: 321.690.1789
LONG BEACH, FL 33472 Email: info@ptc-corp.com
FBPC, C.A. NO. 25835

Robert J. Amoruso, P.E.
Florida P.E. No. 49752

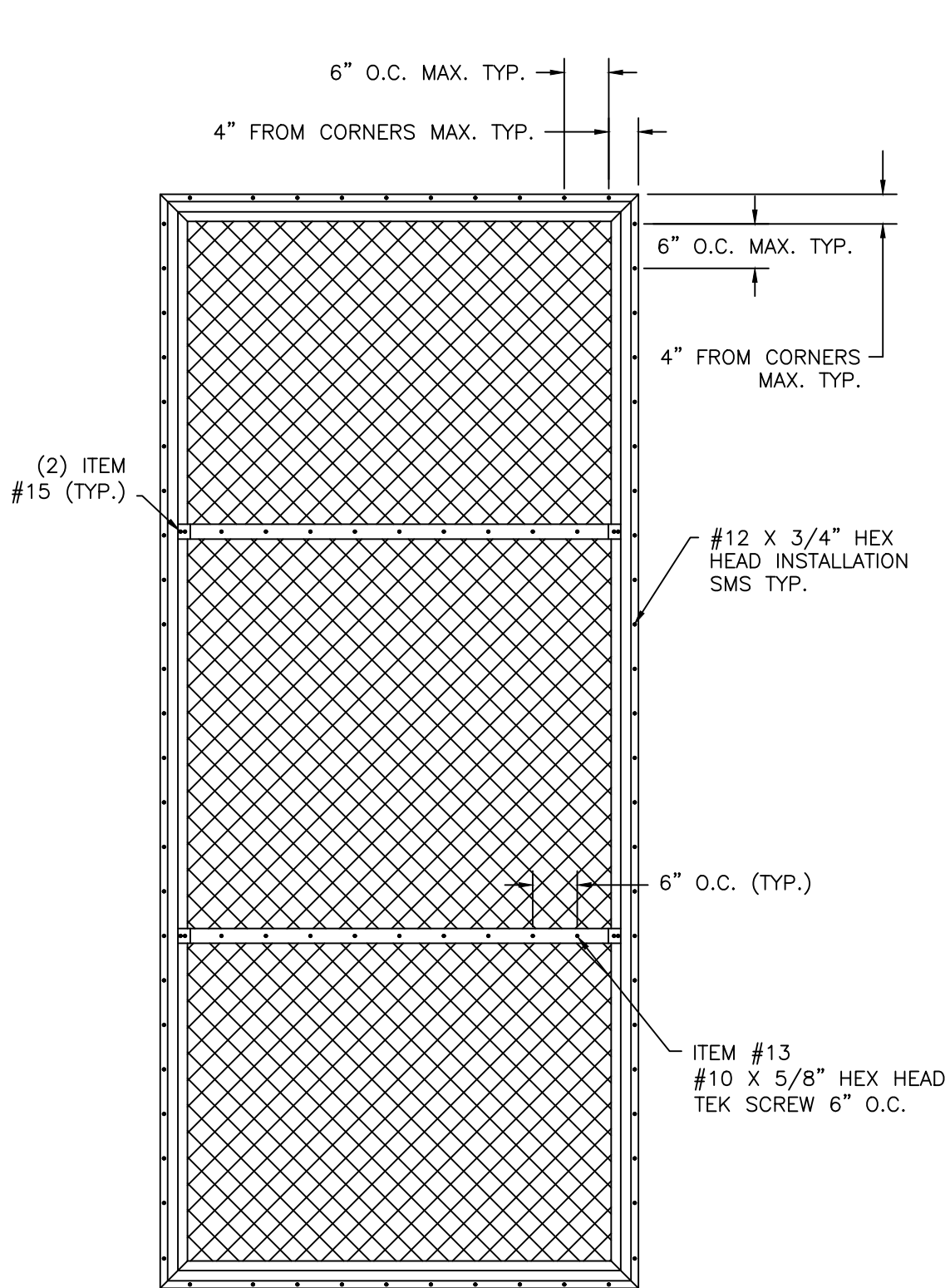

EXTERIOR ELEVATION
PANEL TO ALUMINUM
TUBE ANCHORING

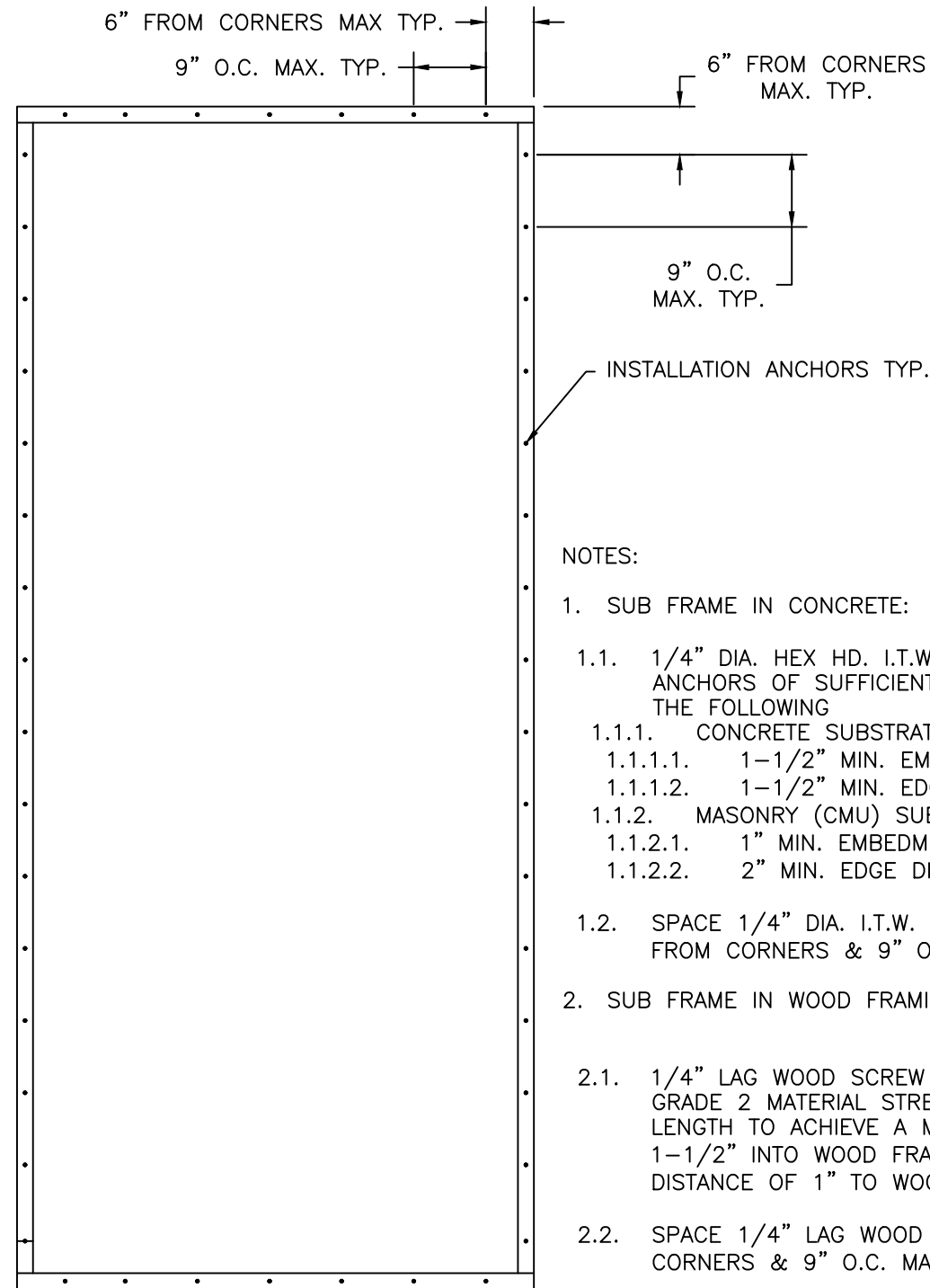

EXTERIOR ELEVATION
ALUMINUM TUBE TO
SUBSTRATE/ WALL
ANCHORING

NOTES:

1. SUB FRAME IN CONCRETE:
 - 1.1. 1/4" DIA. HEX HD. I.T.W. BUILDEX TAPCON ANCHORS OF SUFFICIENT LENGTH TO ACHIEVE THE FOLLOWING
 - 1.1.1. CONCRETE SUBSTRATE
 - 1.1.1.1. 1-1/2" MIN. EMBEDMENT
 - 1.1.1.2. 1-1/2" MIN. EDGE DISTANCE
 - 1.1.2. MASONRY (CMU) SUBSTRATE
 - 1.1.2.1. 1" MIN. EMBEDMENT
 - 1.1.2.2. 2" MIN. EDGE DISTANCE
 - 1.2. SPACE 1/4" DIA. I.T.W. BUILDEX TAPCONS 6" FROM CORNERS & 9" O.C. MAX. THEREAFTER.
2. SUB FRAME IN WOOD FRAMING:
 - 2.1. 1/4" LAG WOOD SCREW ANCHORS WITH MIN. GRADE 2 MATERIAL STRENGTH OF SUFFICIENT LENGTH TO ACHIEVE A MIN. EMBEDMENT OF 1-1/2" INTO WOOD FRAMING AND MIN. EDGE DISTANCE OF 1" TO WOOD FRAMING EDGE.
 - 2.2. SPACE 1/4" LAG WOOD SCREWS 6" FROM CORNERS & 9" O.C. MAX. THEREAFTER.
3. SCREEN FRAME:
 - 3.1. #12 X 3/4" HEX HD. SMS SPACE 4" FROM CORNERS AND 6" O.C. MAX. THEREAFTER.



1661 GLENLAKE AVE.
ITASCA, IL 60143

TITLE: STORMSAFE SCREEN - OPERABLE IMPACT SCREEN - HVHZ
ELEVATION & ANCHOR LAYOUTS

PREPARED BY:	RJA	DATE:	12/09/12
DRAWN BY:	RJA	DRAWING NO.:	QMI0004
SCALE:	N.T.S.	REV:	A
SHEET:	2 OF 5		

PTC PRODUCT DESIGN GROUP, LLC
PO BOX 520775
LONGWOOD, FLORIDA 32752
Phone: 321.680.1788
Fax: 321.680.1785
Email: info@ptc-cdp.com
FBPE C.A. NO. 25835

Robert J. Amoruso, P.E.
Florida P.E. No. 49752

PROJECT #414-1205

REV	DESCRIPTION	DATE	BY
A	UPDATE TO 5TH ED. (2014) FLORIDA BUILDING CODE	5/6/15	RJA

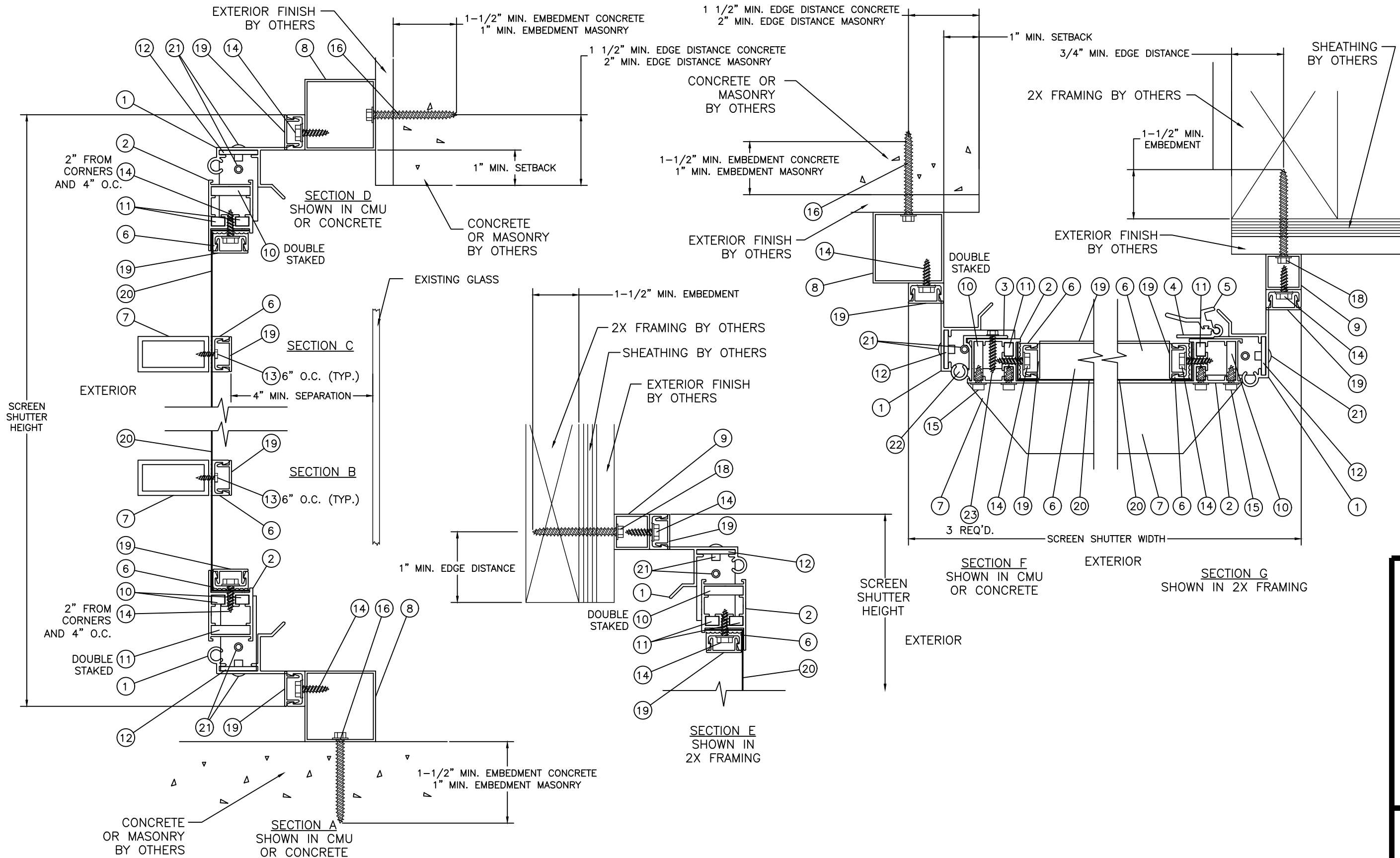

PROJECT #414-1205

1661 GLENLAKE AVE.
ITASCA, IL 60143



TITLE: STORMSAFE SCREEN - OPERABLE IMPACT SCREEN - HVHZ
VERTICAL & HORIZONTAL SECTIONS

DATE:	12/09/12
DRAWN BY:	RJA
SCALE:	N.T.S.
REV:	A
DRAWING NO.:	QMI0004
SHEET:	3 OF 5

Robert J. Amoruso, P.E.
Florida P.E. No. 49752

DATE	5/6/15	BY	RJA
DESCRIPTION	UPDATE TO 5TH ED. (2014) FLORIDA BUILDING CODE	REV	A

PTC PRODUCT DESIGN GROUP, LLC
PO BOX 520775
LONGWOOD, FLORIDA 32752
Phone: 321.690.1788
Fax: 321.690.1789
Email: info@ptc-corp.com
FBPE C.A. NO. 25935

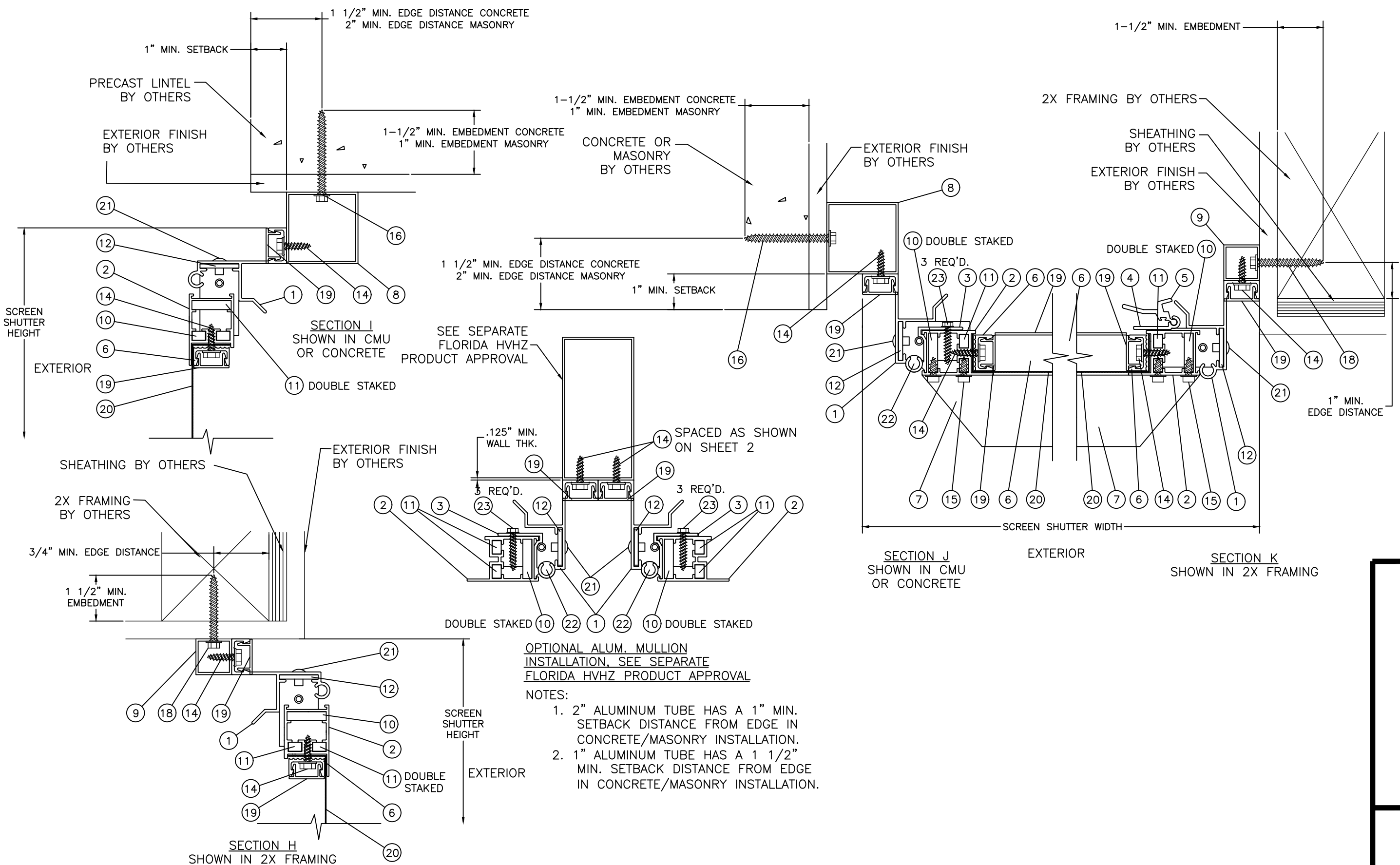

PROJECT #414-1205

1661 GLENLAKE AVE.
ITASCA, IL 60143



TITLE: STORMSAFE SCREEN - OPERABLE IMPACT SCREEN - HVHZ
VERTICAL & HORIZONTAL SECTIONS

DATE:	12/09/12
DRAWING NO.:	QMI0004
SCALE:	N.T.S.
REV.:	A
SHEET:	4 OF 5

BY	RJA
DATE	5/6/15
DESCRIPTION	UPDATE TO 5TH ED. (2014) FLORIDA BUILDING CODE
REV	A

Robert J. Amoruso, P.E.
Florida P.E. No. 49752

① FRAME HEAD, SILL & JAMB
TYP. WALL THICKNESS 0.075

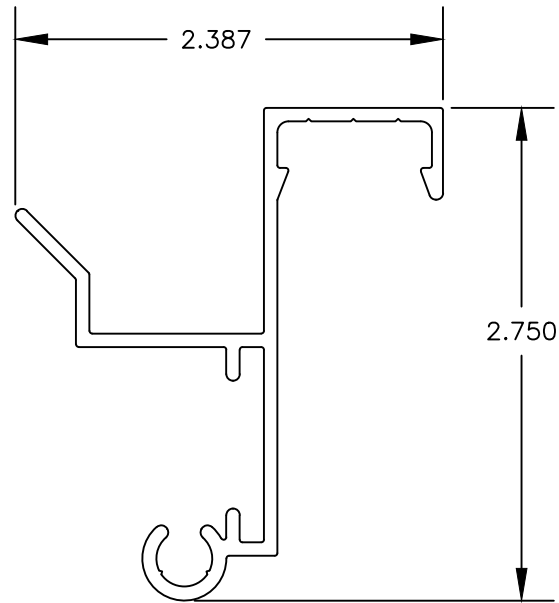

② VENT HEAD, SILL & JAMB, TYP. WALL THICKNESS 0.075

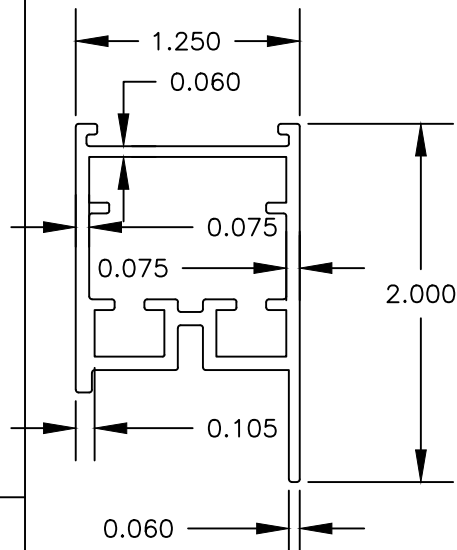

③ SCREEN HINGE
TYP. WALL THICKNESS 0.078

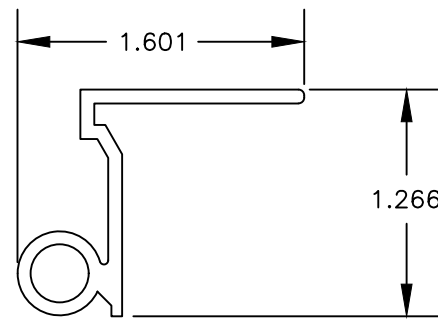

④ SCREEN LOCK PART A
TYP. WALL THICKNESS 0.080

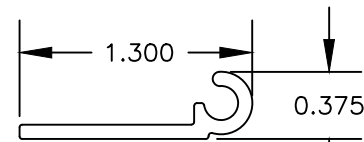

⑤ SCREEN LOCK PART B
TYP. WALL THICKNESS 0.110

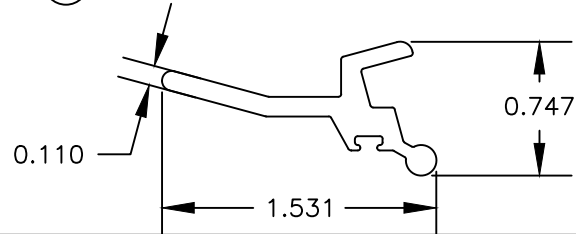

⑥ WIRE RETAINER
TYP. WALL THICKNESS 0.075

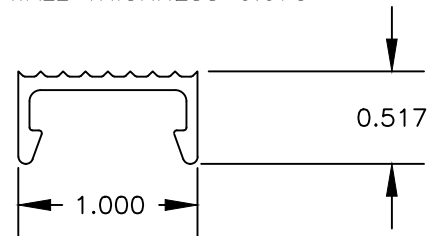

⑦ 1" X 2" ALUMINUM TUBE
TYP. WALL THICKNESS 0.125

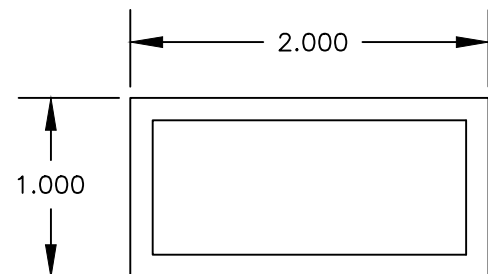

⑧ 2" X 2" ALUMINUM TUBE
TYP. WALL THICKNESS 0.062

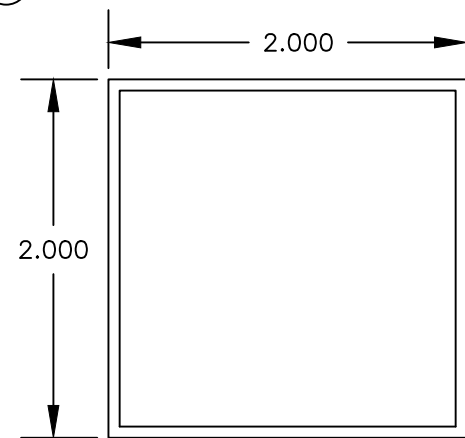

⑨ 1" X 1" ALUMINUM TUBE
TYP. WALL THICKNESS 0.062

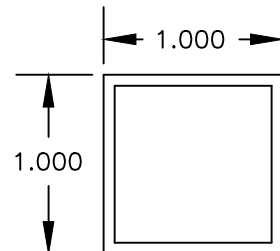

⑱ SCREEN COVER
TYP. WALL THICKNESS 0.050

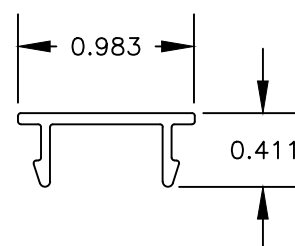

BILL OF MATERIALS

ITEM #	PART #	DESCRIPTION
1	2726	FRAME HEAD, SILL & JAMB 6005-T5 ALUMINUM
2	2711	VENT HEAD, SILL & STILE 6005-T5 ALUMINUM
3	2733	SCREEN HINGE 6005-T5 ALUMINUM
4	2724	SNAP LOCK PART A
5	2725	SNAP LOCK PART B
6	2721	WIRE RETAINER
7		1" X 2" X 1/8" ALUMINUM TUBE 6063-T5
8		2" X 2" X 1/16" ALUMINUM TUBE 6063-T5
9		1" X 1" & 1" X 2" X 1/16" ALUMINUM TUBE 6063-T5
10		OUTER VENT CORNER KEY 2" X 2" X 1.1 X 1/4" 6061-T6 ALUM.
11		INNER VENT CORNER KEY 2" X 2" X .400 X 1/8" 6061-T6 ALUM.
12		SUB FRAME ANGLE CORNER KEY 2" X 2" X 1/8" 6061-T6 ALUM.
13		#10 X 5/8" TEK SCREW
14		#12 -14 X 3/4" HEX HEAD SMS
15		#14 X 1/2" HEX HEAD SELF TAPPING FASTENER
16		1/4" HEX HEAD ITW TAPCON
17		NOT USED
18		1/4" LAG SCREW
19	2730	SCREW COVER
20		MESH 12 X 12 SCREEN SS 304 THREAD 0.028" OR 0.032" THICK
21		1/8" POP RIVET
22		SPRING LOADED HINGE PIN ASSEMBLY
23		#12 X 1" HEX HEAD SELF TAPPING SMS

PROJECT #414-1205

1661 GLENLAKE AVE.
ITASCA, IL 60143

QMI

TITLE: STORMSAFE SCREEN - OPERABLE IMPACT SCREEN - HVHZ COMPONENTS & BILL OF MATERIALS

PREPARED BY: RJA
DATE: 12/09/12
DRAWING NO: QMI0004
SCALE: N.T.S.
SHEET: 5 OF 5
REV: A

PTC PRODUCT DESIGN GROUP, LLC
PO BOX 520775
LONGWOOD, FLORIDA 32752
FBPE.CA. NO. 259535
Phone: 321.680.1788
Fax: 321.680.1789
Email: info@pac-corp.com

Robert J. Amoruso, P.E.
Florida P.E. No. 49752

5/6/15
RJA
UPDATE TO 5TH ED. (2014)
FLORIDA BUILDING CODE
DESCRIPTION
DATE
BY